

# Duplo



[WWW.DUPLOINTERNATIONAL.COM](http://WWW.DUPLOINTERNATIONAL.COM)

FINI FASH  
FINI FASH  
FINI FASH  
UNLEASH  
**UNLEASH  
FLEXIBILITY**

IT'S NOT FINISHED UNTIL IT'S DUPLO.

# DC-618

[WWW.DUPLOINTERNATIONAL.COM](http://WWW.DUPLOINTERNATIONAL.COM)



SOLUTIONS  
SOLUTIONS  
SOLUTIONS  
SOLUTIONS  
**SOLUTIONS**

SLITTER, CUTTER, CREASER

# DC-618 PRODUCT GUIDE

SLITTER/ CUTTER/ CREASER

## Table of Contents

Product Description	3
Product Highlights	4-7
Additional Features	8-10
Comparison with other DC Models	11-12
Comparison with Competitors	13
Space Requirement	14-15
Product Codes	16



# PRODUCT DESCRIPTION

## DC-618

The DC-616 has been one of the most popular models within the Duplo range since its launch in 2014. Over the last six years, the market has evolved and so has the competition, so to enable us to keep ahead of the game within the Slitter, Cutter, Creaser market, Duplo is proud to announce the launch of the **DC-618**. A more powerful entry level model, with additional features and significantly improved specifications from the DC-616/616 Pro.

The fully automated DC-618 Slitter/Cutter/Creaser is Duplo's compact yet powerful all-in-one finishing solution designed for today's digital printer. With the ability to process up to 6 slits, 30 cuts and 20 creases in one pass, the DC-618 delivers full-bleed applications up to 23 sheets per minute without the white borders and toner cracking for a clean finish. Produce an array of on-demand applications with ease including 21-Up business cards, gatefold invitations, direct mailers, brochures, book covers, and much more. Bring your finishing in-house!



# PRODUCT HIGHLIGHTS

## IMPROVED PROCESS SPEED

- Greatly improved process speed compared to its predecessor DC-616.
- 297 mm x 210 mm SEF 2 Cuts, 1 Crease runs at approximately 23 sheets/ minute while the DC-616 processed the same job at 10 sheets/ minute.

Job	Slit	Cut	Crease	Perf	Cross Perf	Finished Size	DC-616 SRA3/ m	DC-618 SRA3/ m	DC-646 SRA3/ m	DC-746 SRA3/ m
21-up Business Card	6	14	0	0	0	54 x 85 mm	4.4	9.2	7.5	18
4-up Greeting Card	4	4	2	0	0	148.5 x 210 mm	6.7	12.5	14	30
8-up Postcard	4	8	0	0	0	105 x 148.5 mm	5	12.8	12.5	24
1-up A3 Brochure	2	2	1	0	0	297 x 420 mm	8.5	16	20	35

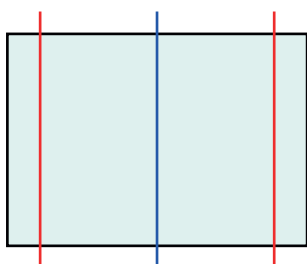

2 Cut, 1 Crease  
from A4

23 ppm

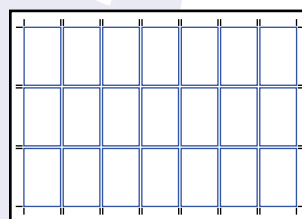

3 x 7 Business Card  
from SRA3

9.2 ppm

# WIDER RANGE OF PAPER

The DC-618 can process up to 400 gsm sheet.

	DC-616/ DC-616 Pro	DC-618
Paper Weight	110 - 350 gsm	110 - 400 gsm

The new width selectable creaser tool allows customers to choose different widths according to the substrate being run. To create heavier stocks, the lower tool has 2 widths: 1.2 mm and 1.5 mm. The width can be switched by turning around the Upper Tool.

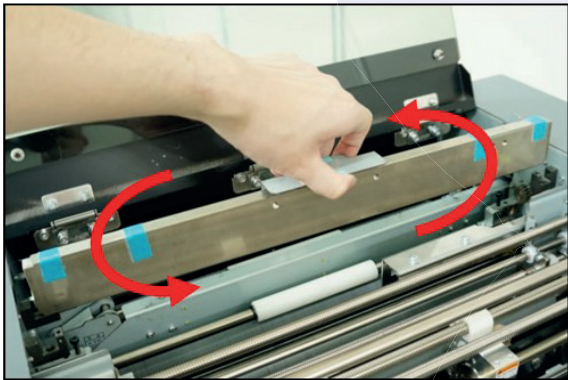
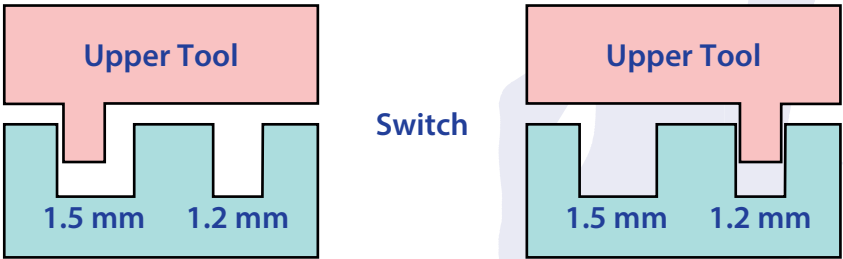

Crease Upper Tool

## REPLACEABLE MODULES

- Different from the other models in the DC range, the DC-616 did not use the replaceable module setup. This could be inconvenient when clearing paper jams.
- Slitters are modularised like the DC-646 and DC-746.
- Slitters modules can be replaced by optional module.

**\*\*The perforation unit is an optional extra, it is not included in the DC-618 as a standard feature\*\***

**DC-616**



**Fixed Slitters**

**DC-618**

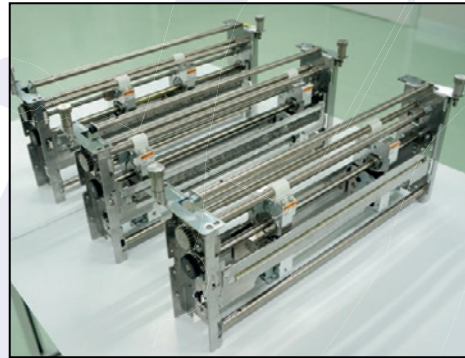

**Slitter Module**

# ENHANCED PC CONTROLLER SOFTWARE INTERFACE

Duplo has modernised the look and feel of the PC Controller interface and it's one of the newest features included with the DC-618. With the software loaded on a Windows PC (sold separately), both new and experienced operators can program jobs with ease, make quick adjustments, and save an unlimited number of jobs onto the hard drive for instant changeovers. Operators can alternatively use the colour LCD control panel for set up and use it to save up to 250 jobs onto the built-in memory.

- User interface has been completely re-designed<sup>1</sup>
- More intuitive operation, easy to use and program jobs<sup>2</sup>
- Crease templates are available<sup>3</sup>

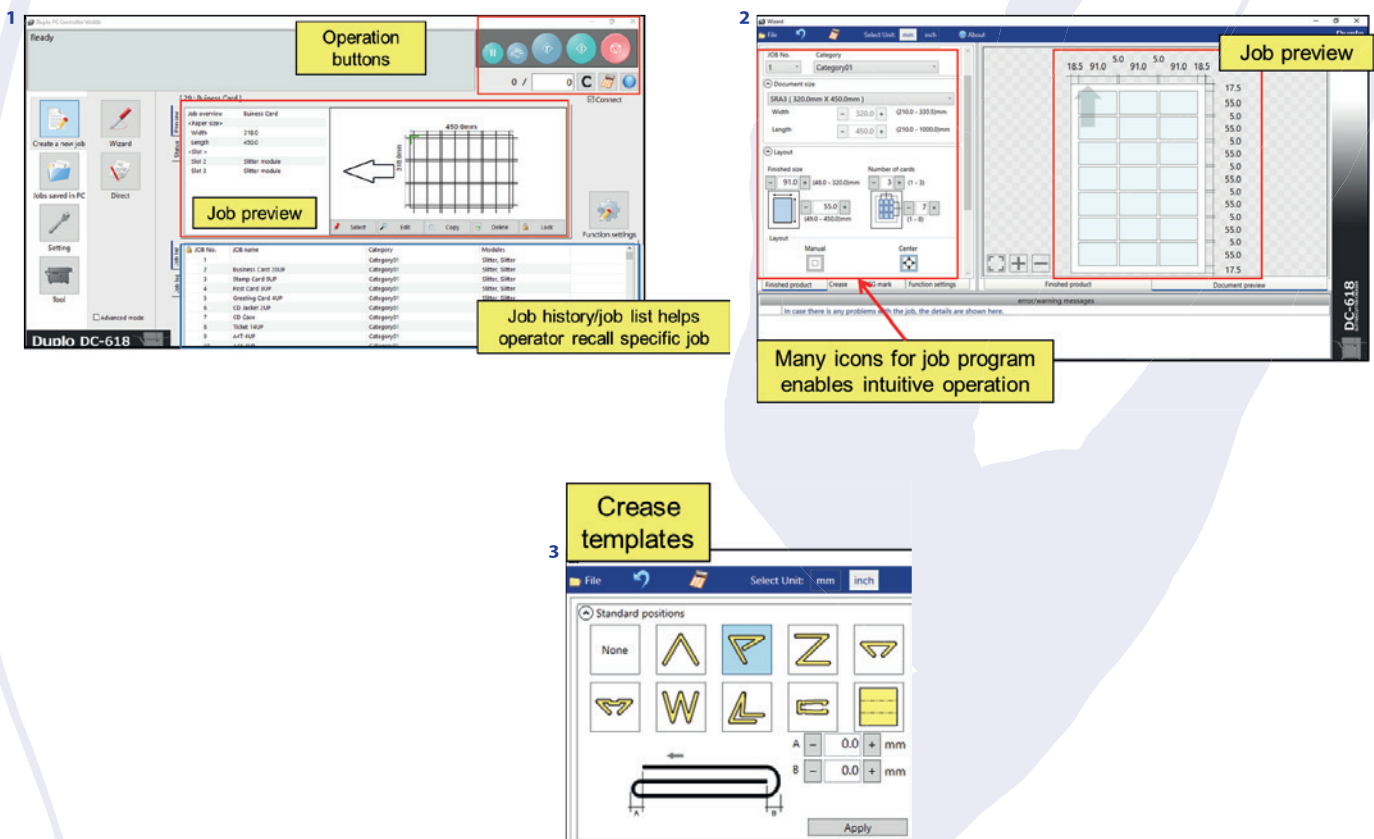



# ADDITIONAL FEATURES

## NEW 115 mm LCD COLOUR TOUCH SCREEN PANEL

The DC-618 breaks away from traditional 64 mm panel and adopts a large LCD colour touch screen panel. It offers improved visibility and operation. Can save up to 250 jobs compared to the 80 jobs of the DC-616.



## AUTOMATIC GUTTER DEFLECTORS

Gutter Deflectors are automatically enabled/ disabled, there is no need to engage and disengage them manually.

DC-616



Manual

DC-618

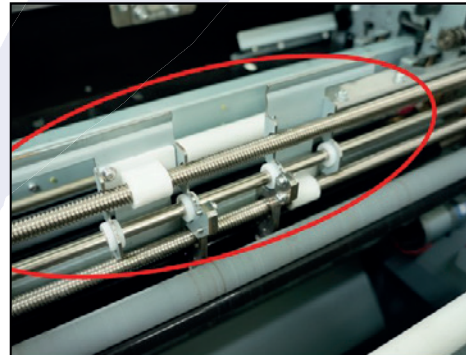

Automatic

# LARGE WASTE BIN

The waste box has increased in size to accomodate the faster speed.

	DC-616/ DC-616 Pro	DC-618
Dimentions (WxDxH)	406 mm x 508 mm x 457 mm	458 mm x 508 mm x 483 mm

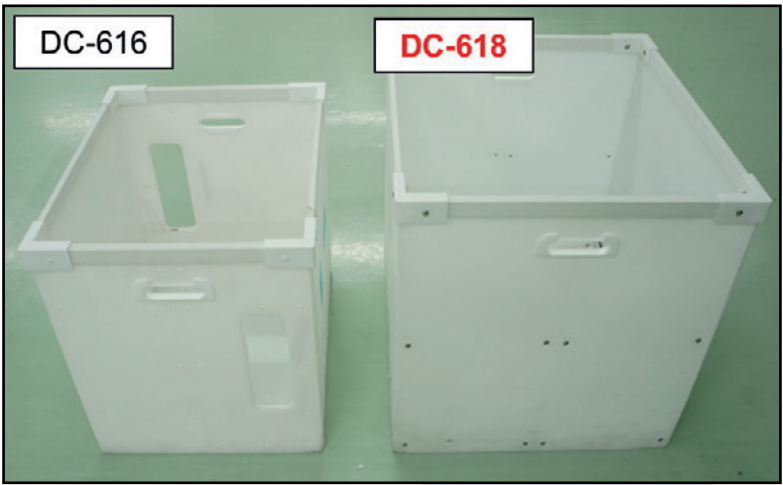

# LONG PAPER TRAY

Long paper tray comes standard, up to 750mm sheets can be loaded.

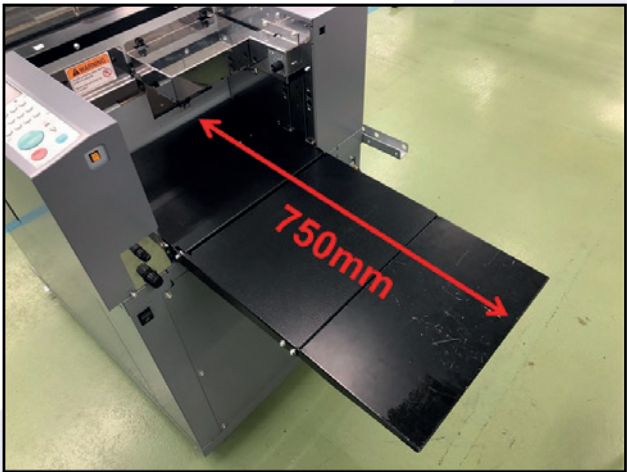

# TRAIL CUT LIMIT

Trail Cut Limit on the last cut has been decreased from 67 mm to 60 mm.

	DC-616/ 616 Pro	DC-618
Trail Cut Limit	67 mm	60 mm

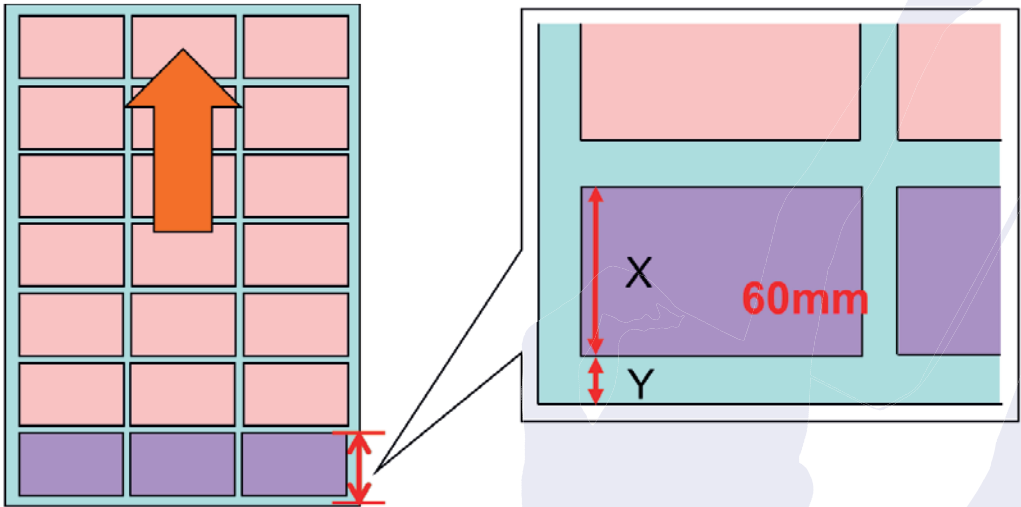

# COMPARISON WITH OTHER DC MODELS

## SPECIFICATIONS

	DC-616	DC-618	DC-646
Max. Sheet Size	W 320 mm x L 460 mm	W 330.5 mm x L 1000 mm	W 370 mm x L 670 mm
Min. Sheet Size	W 210 mm x L 210 mm	W 210 mm x L 210 mm	W 210 mm x L 210 mm
Min. Finished Size	W 48 mm x L 50 mm	W 48 mm x L 50 mm	W 48 mm x L 50 mm
Paper Weight	110 gsm - 350 gsm	110 gsm - 400 gsm	110 gsm - 350 gsm
Feeder/ Exit Capacity	100 mm / 100 mm	100 mm / 100 mm	100 mm / 140 mm
Card Stacker Capacity	40 mm	40 mm	60 mm
Process Speed 2 Cut/ 1 Crease on A4 SEF	CCD off 10ppm CCD on 5ppm	CCD off 23ppm CCD on 19ppm	CCD off 30ppm CCD on 22ppm
Number of Slits/ Cuts/ Crease/ on 1 Document	Max 6 slits Max 25 cuts Max 20 creases	Max 6 slits Max 30 cuts Max 20 creases	Max 8 slits ( 6 slits as standard) Max 30 cuts Max 20 creases
Gutter Deflector	Manual	Automatic	Automatic
Reject Function	No	No	Yes
Job Memory	80	250	250
Tolerance	+/- 0.3 mm (business card: +/- 0.4 mm)	+/- 0.2 mm (business card: +/- 0.3 mm)	+/- 0.2 mm (business card: +/- 0.3 mm)
Optional Perforation	Feeding direction only	Both X/Y direction	Both X/Y direction
Optional Skip Perforation	No skip perforation	Both X/Y direction	Both X/Y direction
Waste Box Capacity	90 litres	114 litres	129 litres
Dimensions (WxDxH)	1,610 mm x 625 mm x 1,060 mm	1,690 mm x 810 mm x 1,125 mm	2,510 mm x 765 mm x 1,110 mm
Weight	145 kg	180 kg	275 kg

## STANDARD FEATURES

Core System	DC-616 e	DC-616Pro	DC-618	DC-646	DC-746
Module Slots	3 Fixed	3 Fixed	3 Removable	4 Removable	5 Removable
Air Knife	Optional	Yes	Yes	Yes	Yes
Ultrasonic Double Feed Sensor	Optional	Yes	Yes	Yes	Yes
CCD Scanner	Optional	Yes	Yes	Yes	Yes
Card Stacker	Optional	Yes	Yes	Yes	Yes
Long Paper Tray	Optional	Yes	Yes	Yes	Yes

PC Control	DC-616 e	DC-616Pro	DC-618	DC-646	DC-746
PC Controller Software	Optional	Yes	Yes	Yes	Yes
PC	Optional	Optional	Optional	Optional	Optional
PC Pole Mount	Optional	Yes	Yes	Yes	Yes
PC Arm with Keyboard	Optional	Optional	Optional	Optional	Optional

Options to Expand Range of Finishing	DC-616 e	DC-616Pro	DC-618	DC-646	DC-746
Perforation Module	Optional	Yes	Optional	Optional	Optional
Rotary Tool Module	No	No	Optional	Optional	Optional
Cross-Perforation Module	No	No	Optional	Optional	Optional
Side Air (for long sheets)	No	No	Optional	Yes	Yes
IFS Folding System	No	No	No	Yes	Yes



# COMPARISON WITH COMPETITORS

## SPECIFICATIONS

	DC-618	Dumor Aerocard Strike	AeroCut One
Max. Sheet Size	W 330.5 mm x L 1000 mm	W 330 mm x L 650 mm	W 370 mm x L 520 mm
Min. Sheet Size	W 210 mm x L 210 mm	W 210 mm x L 210 mm	W 210 mm x L 210 mm
Min. Finished Size	W 48 mm x L 50 mm	W 50 mm x L 48 mm	W 45 mm x L 55 mm
Paper Weight	110 gsm - 400 gsm	110 gsm - 400 gsm	120 gsm - 400 gsm
Feeder/ Exit Capacity	100 mm / 100 mm	105 mm x ? mm	100 mm / ? mm
Process Speed 2 Cut/ 1 Crease on 216 mm x 279.5 mm	CCD off 23ppm CCD on 19ppm	CCD off 20ppm (est.) CCD on ?ppm (est.)	15.4ppm
Process Speed 21 Up Business Cards (SRA3)	CCD off 9ppm CCD on 7ppm	CCD off 6.2ppm CCD on ?ppm	8.8ppm
Number of Slits/ Cuts/ Crease/ on 1 Document	Max 6 slits Max 30 cuts Max 20 creases	Max 6 slits (+4 options) Max 32 cuts Max 16 creases	Max 6 slits Max ? cuts Max ? creases
Gutter Deflector	Automatic	Manual	Manual
Optional Perforation	Both X/Y direction	Both X/Y direction (rule)	Feeding direction only
Skip Perforation	Both X/Y direction	Both X/Y direction	No skip perforation
Perforation Positioning	Automatic	Manual	Manual
Tolerance	+/- 0.2 mm (business card: +/- 0.3 mm)	+/- 0.2 mm (est.)	? mm
Weight	180 kg	150 kg (est.)	260 kg

# SPACE REQUIREMENTS

DC-618

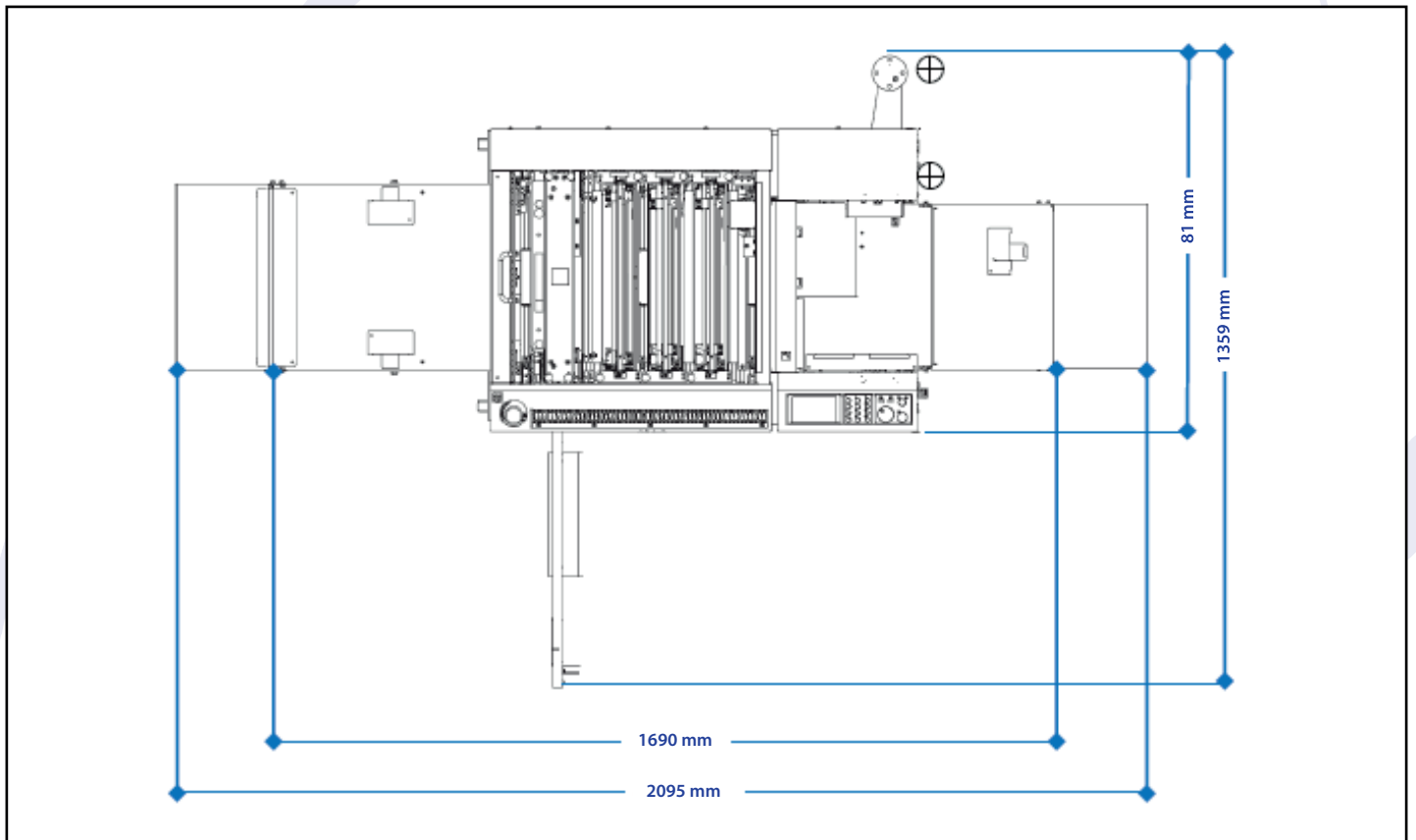

## Power Requirements

DC-618: 230 V, 1.1 A

PC: Depending on the PC

## DC-618 WITH ST-3 STACKER

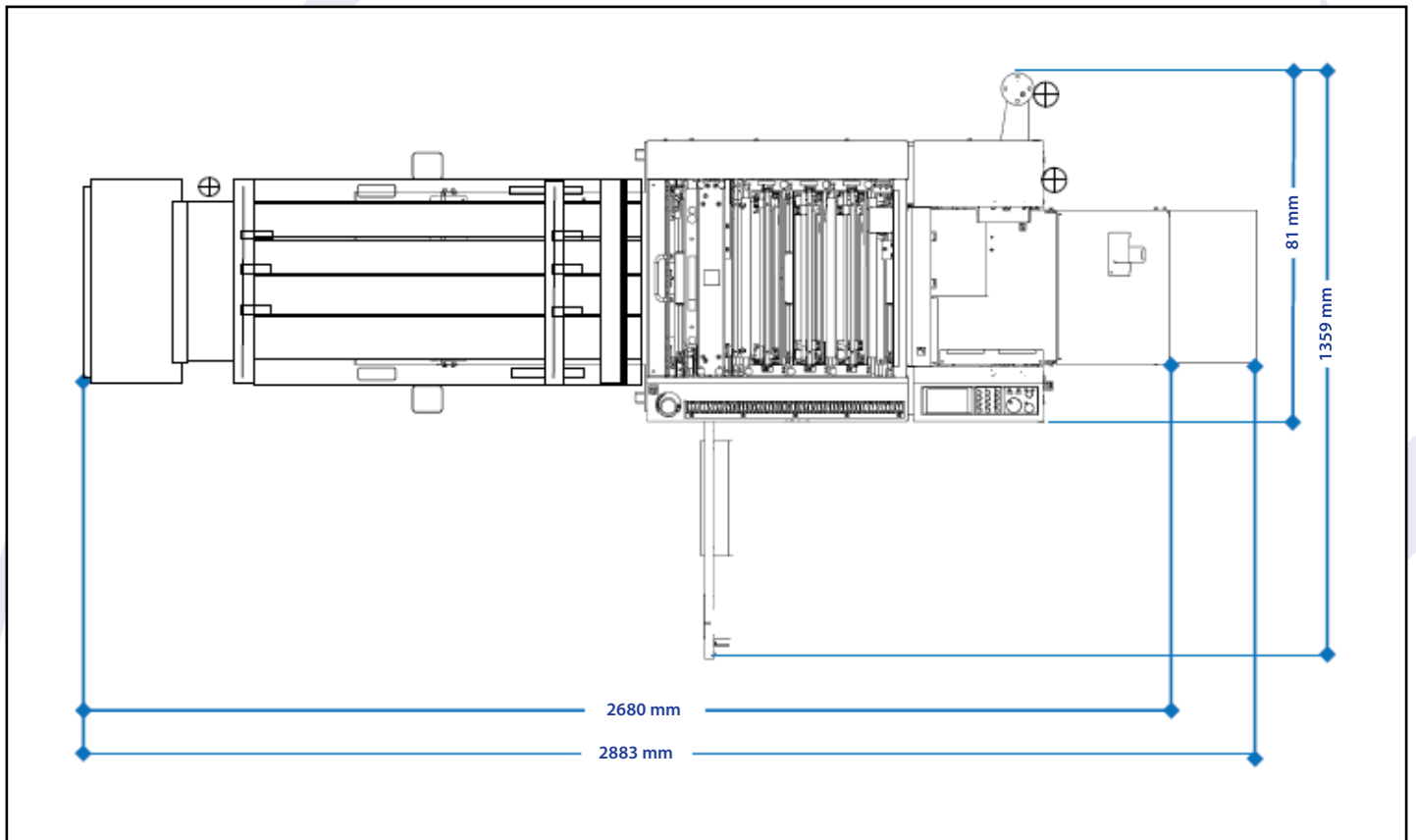

### Power Requirements

DC-618: 230 V, 1.1 A

PC: Depending on the PC

# PRODUCT CODES

## DC-618

Model	Part Number	Description
DC-618 Machine	885-01300	DC-618 Slitter/ Cutter/ Creaser 6 Slits, 30 Cuts and 20 Creases

Options - To be included	Part Number	Description
RTM-08	80C-11087	Rotary Tool Module
PFM-04	80C-11086	Manual Perforation Module
CPM-08	80C-11090	Cross Perforation Module

Optional Extras	Part Number	Description
OMK-13	80C-11088	DC-618 SLOT2 Option Motor Kit
OMK-14	80C-11089	DC-618 SLOT3 Option Motor Kit
AIR-09	80C-11085	Air Knife